



- 1 Hexagonal socket bolt with fine pitch thread
- 2 Guiding plate
- 3 Threaded plate
- 4 Housing
- 5 Grip ring insert (hardened)

The powerful add-on claw

Axial restraint safety claw for use with pressurized pump lines in lifting systems as well as for rainwater sewage lines that are at risk of undergoing back pressures, but only in combination with the NORMACONNECT® DCS RAPID standard collar. The powerful add-on claw for non-pull-out resistant connections.

Materials

| W1 | W2 | W3 | W4 | W5 |
|----|----|----|----|----|
| x | | | | |

- W1**
- Material, Housing: Steel, surface protected
 - Material, Closure unit: Steel, surface protected

Advantages at a glance

- Two parts (halves) with hardened grip ring inserts
- Strong guiding plates with threaded holes plus four hexagonal socket bolts with fine pitch thread

Technical data & Ordering information

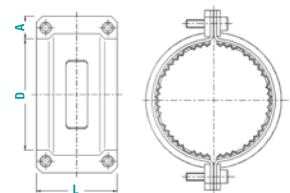

| NORMACONNECT® DCS RECORD CLAW | | | | | | | | |
|-------------------------------|-------|--------|--------|--------|-------------|-----------|-------------|----------------|
| Designation | DN | A (mm) | D (mm) | L (mm) | Torque (Nm) | Bolt (mm) | P max (bar) | W1 Product No. |
| RECORD CLAW DN 40 | 40 | 21 | 65 | 66 | 12-15 | M 8 | up to 10 | 0262 1272 040 |
| RECORD CLAW DN 50 | 50 | 21 | 75 | 69 | 12-15 | M 8 | up to 10 | 0262 1265 050 |
| RECORD CLAW DN 70 | 70 | 21 | 95 | 69 | 12-15 | M 8 | up to 10 | 0262 1266 070 |
| RECORD CLAW DN 80 | 75/80 | 21 | 100 | 69 | 12-15 | M 8 | up to 10 | 0262 1287 080 |
| RECORD CLAW DN 100 | 100 | 25 | 135 | 87 | 25-30 | M 10 | up to 10 | 0262 1246 100 |
| RECORD CLAW DN 125 | 125 | 25 | 160 | 95 | 30-35 | M 10 | up to 5 | 0262 1267 125 |
| RECORD CLAW DN 150 | 150 | 25 | 185 | 95 | 30-35 | M 10 | up to 5 | 0262 1268 150 |
| RECORD CLAW DN 200 | 200 | 30 | 235 | 111 | 60-65 | M 12 | up to 3 | 0262 1269 200 |