

- 1 Hexagonal socket bolts
- 2 Guiding side
- 3 Threaded side
- 4 Housing
- 5 Grip ring insert

## The powerful add-on claw

Our **NORMACONNECT®** DCS Combi Claw is an axial restraint safety claw for connecting rainwater and sewage lines that are at risk of undergoing back pressures. It is used in combination with **NORMACONNECT®** RAPID/RAPID MSM and **NORMACONNECT®** CV or CE standard collars. The powerful add-on claw for non-pull-out resistant connections.

### Materials

W1	W2	W3	W4	W5
x				

- W1**
- Material, Housing: Steel, surface protected
  - Material, Closure unit: Steel, surface protected

### Information

- Axial restraint up to 10 bar
- Diameters DN 50 up to DN 150

### Technical data & Ordering information

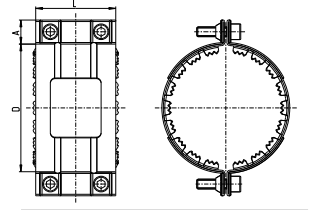

#### NORMACONNECT® DCS COMBI CLAW

Designation	DN	A (mm)	D (mm)	L (mm)	Torque (Nm)	Bolt (mm)	P max (bar)	W1 Product No.
COMBI CLAW DN 50	50	22	81	72	18-20	M 8	up to 10	0262 8590 050
COMBI CLAW DN 70	70	22	102	72	18-20	M 8	up to 10	0262 8590 070
COMBI CLAW DN 80	80	22	110	72	18-20	M 8	up to 10	0262 8590 080
COMBI CLAW DN 100	100	22	136	82	28-30	M 10	up to 10	0262 8591 100
COMBI CLAW DN 125	125	23.5	162	93	28-30	M 10	up to 5	0262 8592 125
COMBI CLAW DN 150	150	23.5	189	93	33-35	M 10	up to 5	0262 8592 150